

# OUTDOOR PRODUCTS CATALOG

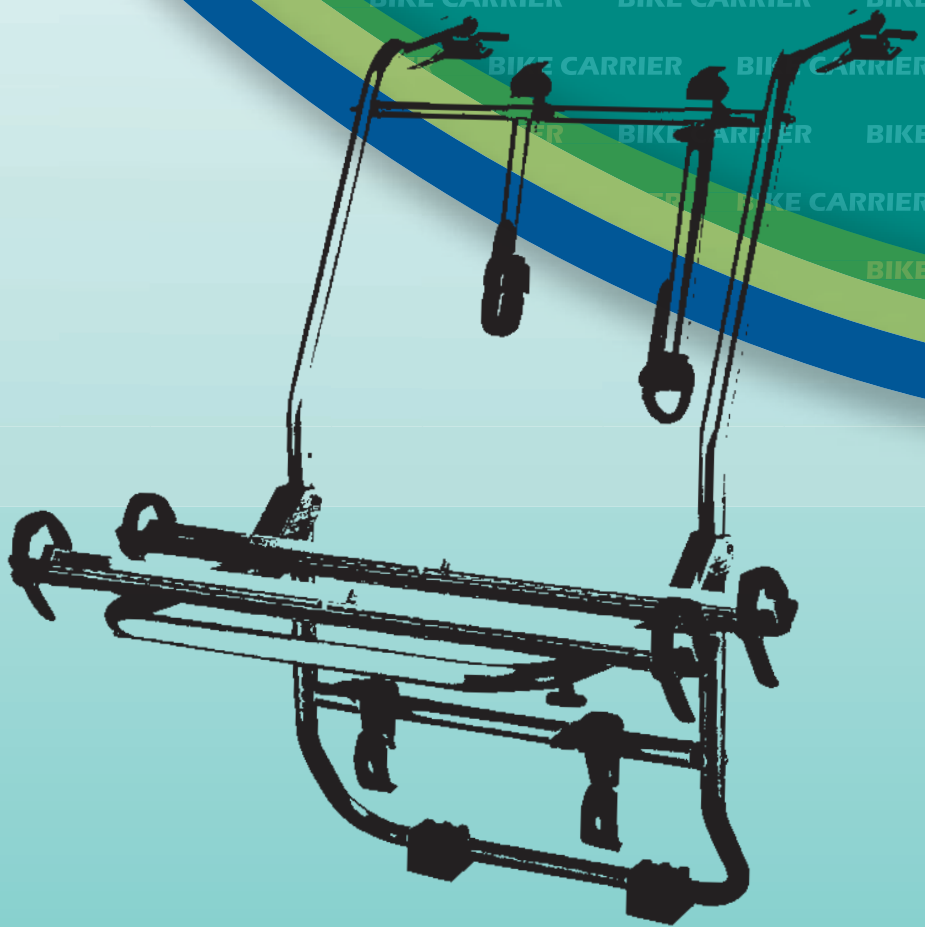

Sunny Technologies Co.,Ltd.

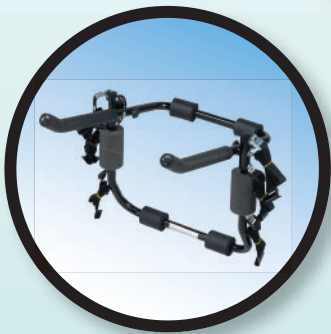

## Company Profile & History

Sunny Technologies Co., Ltd. was founded in 1985. We started from computer cases and power supplies. With 30 years experiences of exporting, that is the reason why we have got good reputation worldwide.

From 2007, we expanded our product line to bike and vehicle accessories. We have been dedicating to research different types of bike carries from interior to external application, which is including bike carrier, bike rack, bike accessories, and vehicle accessories.

From 2014, we develop more outdoor relative products, which is including fishing, water activities, and cooling maker (portable air conditioner can be used inside a vehicle, a dining car, a camping car, or a tent, and also fit into small spaces in the office, bedroom, or living room). Our aim is to provide best quality, service, and competitive products.

Under the continuous efforts of our team, we've won the trust and reputation from OEM and ODM customers. Our customers are worldwide and appreciate our good supports.

Welcome contact us!



## Content

### BIKE CARRIER

- Hitch Type Series ..... 3~5
- Rear Type Series ..... 6~10
- Roof Type Series ..... 11~14

### OUTDOOR PRODUCTS

- Wheelchair Carrier & Umbrella ..... 15~16
- Portable Cooler ..... 17
- Cooler Box ..... 18
- Fishing Net ..... 19~20

## Hitch Type Series

### SB-10-226K

#### Hitch-Mount Bike Carrier

Suitable model: Fits for most vehicles with hitch receiver

Material: Steel & Plastic

Max load: 30 kgs/carries up to 2 bikes

- Feature:
- Fits 32mm & 50mm hitch receiver
  - Folds up when not required
  - Tilts down with bikes for trunk accessibility
  - With lock
  - Easily mounted



### SB-10-228AK

#### Hitch-Mount Platform Bike Carrier

Suitable model: Fits for most vehicles with hitch receiver

Material: Steel & Plastic

Max load: 30 kgs/carries up to 2 bikes

- Feature:
- Fits 32mm & 50mm hitch receiver
  - Folds up when not required
  - Tilts down with bikes for trunk accessibility
  - With lock
  - Easily mounted



### SB-10-231

#### Hitch-Mount E-Bike Carrier

Suitable model: Fits for most vehicles with hitch receiver

Material: Steel & Plastic

Max load: 60 kgs/carries up to 2 E-bikes

- Feature:
- Fits 50mm hitch receiver
  - Folds up when not required
  - Tilts down with E-bikes for trunk accessibility
  - With lock



### SB-11-201

#### 2 Bicycles Hitch Mount Bike Carrier

Suitable model: Apply in inquired receiver of vehicles

Material: Steel with Black Powder Coating

Max load: 30 kgs/carries up to 2 bikes.

- Feature:
- Fits 1-1/4" & 2" receivers
  - Upright arm can be folded sideway for easy rear vehicle access
  - Carry a wide variety of bike by utilizing adjustable wheel trays
  - Patented soft rubber ratchet arms hold bikes securely in place and will not damage bike
  - Reflective stickers included
  - Quick bike loading & removal
  - Easy to assemble and install
  - Anti-sway hitch pin included
  - Convenient to store when it is not used



If your car come with spare tyre, maybe need an extender  
please contact us regarding to hitch extender (not included)

## Hitch Type Series

### SB-11-218

#### 2 Bicycles Hitch Mount Bike Carrier

Suitable model: Fits 1-1/4" & 2" receivers

Material: Steel with Black Powder Coating

Max load: 30 kgs/carries up to 2 bikes

- Feature:
- Carry a wide variety of bike by utilizing adjustable wheel trays and fork mounts
  - 9mm skewer included
  - Quick bike loading & removal
  - Easy to assemble and install
  - Convenient to store when it is not used
  - Anti-sway hitch pin included
  - Convenient to store when it is not used



### SB-11-218A

#### 2 Bicycles Hitch Mount Bike Carrier

Suitable model: Fits 2" receivers

Material: Steel with Black Powder Coating

Max load: 30 kgs/carries up to 2 bikes

- Feature:
- Carry a wide variety of bike by utilizing adjustable wheel trays and fork mounts
  - 9mm skewer included
  - Easy to assemble and install
  - Convenient to store when it is not used
  - Quick bike loading & removal
  - Anti-sway hitch pin included



### SB-11-202

#### 4 Bicycles Hitch Mount Bike Carrier

Suitable model: Apply in inquired receiver of vehicles

Material: Steel with Black Powder Coating

Max load: 60 kgs/carries up to 4 bikes

- Feature:
- Fits 2" receivers
  - Stalk can be tilted for easy rear vehicle access
  - Special cradles & Velcro hold bikes securely without scratching or crushing bike frame
  - Easily fold down top arm for safety
  - Folds flat for storage
  - Quick bike loading & removal
  - Easy to assemble and install
  - Anti-sway hitch pin included



### SB-11-216

#### 4 Bicycles Hitch Mount Bike Carrier

Suitable Model: Fits 1-1/4" & 2" receivers

Material: Steel with Black Powder Coating

Max load: 60 kgs/carries up to 4 bikes

- Feature:
- Stalk can be tilted for easy rear vehicle access
  - Special cradles & Velcro hold bikes securely without scratching or crushing bike frame
  - Easily fold down top arm for safety
  - Folds flat for storage
  - Quick bike loading & removal
  - Easy to assemble and install
  - Anti-sway hitch pin included



### SB-11-217

#### 4 Bicycles Hitch Mount Bike Carrier

Suitable Model: Fits 2" receiver

Material: Steel with Black Powder Coating

Max load: 60 kgs/carries up to 4 bikes

- Feature:
- Tilted for easy rear vehicle access
  - Velcro straps and cushioned cradles hold bikes securely without scratching or crushing bike frame
  - Quick bike loading & removal
  - Easy to assemble and install
  - Anti-sway hitch pin included
  - Convenient to store when it is not used





## Hitch Type Series

### SB-10-224

#### Hitch-Mount Bike Carrier

Suitable model: For most vehicles (sedan, hatchback)

Material: 1.2" bike support arms in Steel Tube, Plastic

Max load: 45 kgs/carries up to 3 bikes

- Feature:
- Easy folded
  - Easily Stored, space saving, easily mounted
  - Tilts down with bikes for trunk accessibility

**SB-10-224A** Fits 32 & 50mm hitch receiver, w/o lock

**SB-10-224AK** Fits 32 & 50mm hitch receiver, with lock

**SB-10-224B** Fits 50mm tow ball, w/o lock

**SB-10-224BK** Fits 50mm tow ball, with lock



### SB-11-203

#### 2 Bike Trunk Carrier

Suitable model: Fits most sedans, hatchbacks, minivans, and SUVs

Material: Steel with Black Powder Coating

Max load: For 30 kgs/2 bikes

- Feature:
- Simple, sturdy bike carrying system
  - Soft Cushion leg pads protect vehicles
  - Easy install design, No drilling required
  - Folds in seconds for easy storage
  - Secured by adjustable straps



### SB-11-220

#### 2 Bike Trunk Carrier

Suitable model: For most of car styles

Material: Steel with Black Powder Coating

Max load: 30 kgs/carries up to 2 bikes

- Feature:
- Simple, sturdy bike carrying system
  - Soft Cushion leg pads protect vehicles
  - Easy install design, No drilling require
  - Folds in seconds for easy storage
  - Secured by adjustable straps

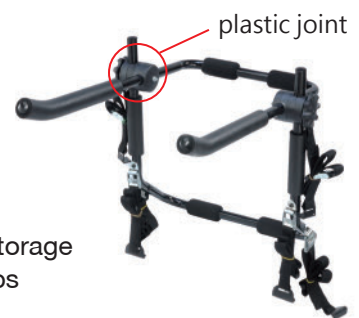

## Rear Type Series

### SB-10-221

#### Rear Bike Carrier

Suitable model: For most vehicles (sedan, hatchback)

Material: Steel & Plastic

Max load: 45 kgs/carries up to 3 bikes

- Feature:
- Easy folded
  - Easily Stored, space saving, easily mounted



### SB-10-222

#### Rear Bike Carrier

Suitable model: For most vehicles (sedan, hatchback)

Material: Steel & Plastic

Max load: 30 kgs/carries up to 2 bikes

- Feature:
- Easy folded
  - Easily Stored, space saving, easily mounted



### SB-10-223

#### Rear Bike Carrier

Suitable model: For most vehicles (sedan, hatchback)

Material: Steel & Plastic

Max load: 30 kgs/carries up to 2 bikes

- Feature:
- Easy folded
  - Easily Stored, space saving, easily mounted



### SB-11-204

#### Dual Purpose Rear Steel Economic Bike Carrier

Suitable Model: For Sedan, MPVs, RV, SUVs

Material: Steel

Max load: 45 kgs/carries up to 3 bikes

- Feature:
- Adjustable joint and structure and easy for installation
  - Foldable and easy to store
  - With velcro clamp
  - Bikes held independently by plastic holders and Velcro
  - Beefy plastic cams and levers.
  - Foam padding (non skid) protects vehicles



\*\*Australia exclusive

## Rear Type Series

### SB-10-201-3C

#### 3 Bicycles Rear Steel Rubber Bike Carrier

Suitable Model: Fit on all sedan, station wagon, hatchback, 3,4 and 5 door vehicles (without spoiler or with low spoiler)

Material: Steel

Max load: 45 kgs/carries up to 3 bikes

Feature:

- Full adjustable with quick release cam lever
- Easy to install and to remove, fold up to store
- Easily mounted with tightening sturdy strap for fixation of bikes included

Arms: cradle type



### SB-10-217

#### Rear Bike Carrier

Suitable model: Fits most vehicles (sedan, hatchback)

Material: 1" Steel Tube, Plastic

Max load: 45 kgs/carries up to 3 bikes

Feature:

- Easily folded
- Easily Stored, space saving, easily mounted



### SB-10-218

#### Rear Bike Carrier

Suitable model: Fits most vehicles(sedan, hatchback, SUV)

Material: 1" Steel Tube, Plastic

Max load: 45 kgs/carries up to 3 bikes

Feature:

- Adjustable arm angle
- Easily folded
- Easily Stored, space saving, easily mounted



### SB-10-219

#### Rear Bike Carrier – bike support arm width: 380mm

### SB-10-219S

#### Rear Bike Carrier – bike support arm width: 290mm

Suitable model: For most vehicles (sedan, hatchback, SUV)

Material: Steel & Plastic

Max load: 45 kgs/carries up to 3 bikes

Feature:

- Easy folded
- Easily Stored, space saving, easily mounted



## Rear Type Series

### SB-15-250 Bike Carrier

Suitable model: for normal sedan  
Material: Steel  
Max. load: 45 kgs/carries up to 3 bikes  
Color: Powder coating silver



### SB-15-252 Bike Carrier

Suitable model: for normal sedan, hatchback, SUV  
Material: Steel  
Max. load: 45 kgs/carries up to 3 bikes  
Color: Powder coating silver



### SB-15-254 Bike Carrier

Suitable model: for SUV or Van  
Material: Steel  
Max. load: 45 kgs/carries up to 3 bikes  
Color: Powder coating silver



### SB-16-202 (Bike Carrier) Rear Mounted Aluminum Alloy Carrier

Suitable model: For MPV, RV, SUV  
Material: 6063 lightweight Aluminum Alloy  
Max load: 30 kgs/carries up to 2 bikes.  
Certification: TUV/CHC

Feature:

- Adjustable platform for position, will not cover rear light & number plate.
- Quick & easy design for ratchet.
- No additional tools required.
- Platform can be easily folded and storage.
- Special rubber for vehicles protection.
- Polished for smooth finish for hand feeling.
- Convenient bike loading with wheel straps.

Caution: Non-suitable for fiberglass rear door and large spoiler.





## Rear Type Series

### SB-16-201 / SB-16-201S

#### Rear Mounted Aluminum Alloy Bike Carrier Rear Mounted Lightweight Bike Carrier

Suitable Model: For MPVs, RV, SUVs

Material: 6063 lightweight Aluminum Alloy

Max load: 30 kgs/carries up to 2 bikes.

Certification: TUV/CHC

Feature:

- Adjustable platform for position, will not cover rear light & number plate.
- Quick & easy design for ratchet.
- No additional tools required.
- Platform can be easily folded and storage.
- Special rubber for vehicles protection.
- Polished for smooth finish for hand feeling.
- Convenient bike loading with wheel straps.

Caution: Non-suitable for fiberglass rear door and large spoiler.



#### Key Features

The best-selling product rear mounted bike carrier for car is made from 6063 lightweight aluminum alloy. There is an adjustable platform that will not cover rear light and number plate. No additional tools required for quick and easy use. E-mail us now for more information.

### SB-16-216

#### Rear Sedan Bike Carrier

Suitable model: For General Sedan Vehicles

Material: 6063 lightweight Aluminum Alloy

Max load: 30 kgs/carries up to 2 bikes.

Certification: ARTC

Feature:

- The bike carrier does not obstruct the rear lights & number plate.
- Bike carrier can be easily folded for storage.
- Convenient bike loading with wheel straps.
- Accordance with the length and height of the trunk lid, adjust the length of the tube of the frame.



## Rear Type Series

### SB-16-214

#### Rear Sedan Bike Carrier

Suitable model: For General Sedan Vehicles

Material: 6063 lightweight Aluminum Alloy

Max load: 30 kgs/carries up to 2 bikes.

Certification: ARTC

Feature:

- The bike carrier does not obstruct the rear lights & number plate.
- Bike carrier can be easily folded for storage.
- Convenient bike loading with wheel straps.

Caution: Non-suitable for large spoiler.

Optional Accessories: SB-16-215



### SB-16-215

#### Knobs with Lock (2pcs/set)

Suitable model: Fits for SB-16-214

Feature:

- Vehicle to bike carrier is lockable.
- To prevent the bike carrier from being stolen.



### SB-10-233

#### 3 Bicycles Rear Spare Tire Carrier

Material: Steel & Plastic

Max load: 45 kgs/carries up to 3 bikes

Feature:

- For rear spare tire (please advise left or right type)
- Fits 14" ~ 20" tire
- Easily folded, easily stored, easily mounted, space saving
- Arms: cradle type



### SB-16-204

#### Spare-tire Aluminum Alloy Bike Carrier

Suitable Model: Spare-tire type MPVs, RV, SUVs  
(fit both left/right type)

Material: 6063 lightweight Aluminum Alloy

Max Load: For 2 bikes (30 kg)

Certification: ARTC

Feature:

- Position adjustable platform
- Platform can be easily folded for storage
- Convenient bike loading with wheel strap.

Caution: Requiring the removal of spare tire cover



## Roof Type Series

### SB-10-202A

#### Roof Mounted Aluminum Alloy 1 Bike Carrier

Suitable model: For all types of roof cross bars

Material: Aluminum U Base, Steel Handle, Plastic

Max load: 15 kgs/carries up to 1 bike

- Feature:
- Adjustable quick release straps for different wheel sizes (fit any size bike)
  - Lockable for securing the bike
  - Fit most cross bars: Max. thickness: 25mm, Max. width: 85mm



### SB-10-203A

#### Roof Mounted Aluminum Alloy 1 Bike Carrier With Lock

Suitable model: For all types of roof cross bars

Material: Aluminum U Base, Steel Handle, Plastic

Max load: 15 kgs/carries up to 1 bike

- Feature:
- Adjustable quick release straps for different wheel sizes (fit any size bike)
  - Lockable for securing the bike
  - Hook-on & Slide-in
  - Fit most cross bars: Max. thickness: 25mm Max. width: 75mm
  - Fit square and aero crossbars brands: Thule, Rhino, Ralo, Prorack
  - Easy mounting
  - Including all accessories with Lock



### SB-10-213

#### Roof Bike Carrier

Suitable model: For all types of roof cross bars

Material: Aluminum U Base, Steel Handle, Plastic

Max load: 15 kgs/carries up to 1 bike

- Feature:
- Adjustable quick release straps for different wheel sizes (fit any size bike)
  - Lockable for securing the bike
  - Fit most cross bars within 85mm
  - Easy mounting
  - Including all accessories with Lock



### SB-10-215

#### Roof Bike Carrier

Suitable model: For all types of roof cross bars

Material: Aluminum U Base, Steel Handle, Plastic

Max load: 15 kgs/carries up to 1 bike

- Feature:
- Fork mounted
  - For open dropout fork
  - Fit most cross bars within 85mm
  - Adjustable quick release straps for different wheel sizes (fit any size bike)
  - Lockable for securing the bike
  - Including all accessories with Lock, easily mounted

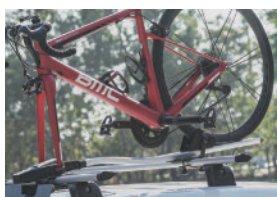

## Roof Type Series

### SB-10-214

#### Wheel Carrier

- Feature:
- Folds down when not required
  - Only applies to front wheel of bike

\*\*This is the option accessories for SB-10-215 Roof Bike Carrier



### SB-10-212

#### Roof Mounted Aluminum Alloy 1 Bike Carrier With Lock

Suitable model: For all types of roof cross bars

Material: Aluminum U Base, Steel Handle, Plastic

Max load: 15 kgs/carries up to 1 bike

- Feature:
- Adjustable quick release straps for different wheel sizes (fit any size bike)
  - Lockable for securing the bike
  - Fit most cross bars within 85mm
  - Easy mounting
  - Including all accessories with Lock

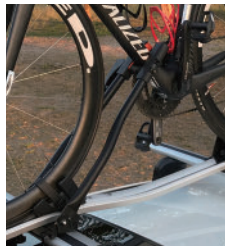

### SB-11-206

#### Roof Top Bike Carrier

Suitable Model: For roof of vehicle loading roof cross bar

Material: Steel with Black Powder Coating

Max load: 15 kgs/carries up to 1 bike

- Feature:
- No need to take the front wheel off.
  - Lockable feature keeps bike secure while in transit.
  - Tie-down straps for wheels included
  - Easily secures the bike frame and holds it steadily
  - Fit square and aero cross bar brands: Thule, Rhino, Ralo, Prorack
  - Will fit all size bicycles



### SB-11-206A

#### Roof Top Bike Carrier

Suitable mold: For roof of vehicle loading roof cross bar

Material: Steel with Black Powder Coating

Max load: 15 kgs/carries up to 1 bike

- Feature:
- Secure front fork of bike once the front wheel is removed
  - 9mm skewer attached
  - Tie-down straps for wheels are included





## Roof Type Series

### SB-16-205

#### Fork Mounted Aluminum Alloy Bike Carrier

Suitable model: Apply in inquired horizontal rack of vehicles

Material: 6063 lightweight Aluminum Alloy

Max load: 20 kg/carries up to 1 bike.

- Feature:
- Loading 1 bike & for unloading front wheel
  - No need tools & quick, easily installed and loading.
  - Fitting for roof rack up to height 1.6 from 3.5 cm & max to 7.5 cm in width
  - Adjustable fixed belt can be fit wheel size up to 2.3 inches.



#### Optional Accessories:

##### Fork Up Adaptor for Front Wheel Stand

Suitable model: Fits for SB-16-205

##### SB-16-209-12mm

12mm axle/inside diameter, 100mm axle/tube width

##### SB-16-209-15mm

15mm axle/inside diameter, 100mm axle/tube width

##### SB-16-209-15mm-1

15mm axle/inside diameter, 110mm axle/tube width

##### SB-16-209-20mm

20mm axle/inside diameter, 110mm axle/tube width

- Feature:
- 12mm, 15mm or 20mm axle/inside diameter
  - Fork up installs easily on fork before loading onto racks
  - It's easier then installing your front wheel.



### SB-16-206

#### Quick Released with Lock

Suitable model: Fits for SB-16-205

Feature:

- Locked in the bike fork and quick release stand of carrier
- To prevent bike from being stolen.



### SB-16-218

#### Front Wheel Stand

- Feature:
- Placement the unloading front wheel.
  - Fits roof racks with T-tracks.

Suitable model: Fits for SB-16-205



### SB-16-207

#### Roof Mounted Aluminum Alloy 2 Bikes Carrier

Suitable model: Apply in inquired horizontal rack of vehicles

Material: 6063 lightweight Aluminum Alloy

Max load: 30 kgs/carries up to 2 bikes.

- Feature:
- Strongly construction and lightweight.
  - Unique platform design with one shape for loading 2 bike.
  - No need tools & quick, easily installed and loading.
  - No need to unload any wheels.
  - Fitting for roof rack up to height 1.6 from 3.5 cm & max to 7.5 cm in width

Caution: Need to use the brake belt when loading bike.



## Roof Type Series

### SB-16-220

#### Fork Mounted Aluminum Alloy Bike Carrier with Lock

Suitable model: Apply in inquired horizontal rack of vehicles

Material: 6063 lightweight Aluminum Alloy

Max load: 20 kgs/carries up to 1 bike

Feature: • The carrier is loading 1 bike & must unloading front wheel

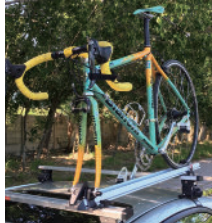

### SB-16-208

#### In Car Bike Carrier

Suitable Model: For most of vehicles of inside of SUVs, MPVs, RV

Material: 6063 lightweight Aluminum Alloy

Size: 111cm-156cm

Feature: • Loading 2-3 bikes & for unloading front wheel  
• With adjustable bar  
• No tools are required.  
• The 3rd fork stand and quick release is sold separately  
• The fork stand and quick release can be adjustable into 90 degree



### SB-16-208A

#### The Fork Mounted Stand and Quick Release

Suitable model: Fits for SB-16-208

Material: 6063 lightweight Aluminum Alloy



### SB-11-207

#### In Car Bike Carrier

##### (Cam Buckle Cargo Bar + Bike Mount + Wheel Mount)

Suitable model: For most of vehicles of inside of trucks, vans, mini vans, SUVs, MPVs and RV

Material: Steel + 6061 T5 Aluminum Alloy with hammertone powder coating

Size: (A). Bar: 40 inches to 70 inches (101cm to 177cm)

(B). Bike mount: Fit normal size fork. Not for oversize 14mm axle

Feature: • Loading 2 bikes & for unloading front wheel, secure bikes in your vehicle  
• With adjustable bar from 40" to 70"  
• Installs with a simple twist of your hand  
• No tools are required  
• Constructed of high-quality steel  
• Patented telescopic rod



Bike Mount



Cam Buckle Cargo Bar



Wheel Mount

### SB-11-219

#### In-Car Bike Carrier

Suitable model: For trucks, vans, mini vans and SUVs

Material: Steel + 6061 T5 Aluminum Alloy

Feature: • Secure bikes in your vehicle • Adjusts from 40" to 74"  
• No tool required • Constructed of high-quality steel  
• Installs with a simple twist of your hand



## Healthy Appliance

**SB-10-230**

**NEW**

### Wheelchair Carrier for Disability

Suitable Model: Fit on Sedan, RV, Hatchback and SUV

Material: Aluminum Wheel Tracks, Steel Tube and Plastic

Max Load: 20 Kgs/Carries Up to 1 Wheelchair

#### Advantages

Adjustable Quick Release Hub and Suitable for Sedan, RV, Hatchback and SUV With Lock

Easy Mounted and Quite Convenient



#### Key Features

The rear wheelchair carrier is designed because of disability of the elderly people. It is not convenient to take a wheelchair carrier out, so the wheelchair rack design idea came out to make go out and travel easier, and save space inside car. Welcome to contact us for detailed information of this wheelchair carrier for car.

#### Product Invention Story

Since the disability of mother, she needs wheelchair everywhere. However, the wheelchair is not easy to carry out. This wheelchair carrier is prompted by this reason and the filial duty of the inventor. After design and manufacturing, now the inventor can go out and travel with his mother easily with convenience.

**SH-AA-001**

**NEW**

### Umbrella for 2 Persons with Supporting Rail attach on Wheelchair





## Healthy Appliance

### SA-19-201

#### 2-in-1 Umbrella

This umbrella can be separated to 2 parts - a Walking Stick and an Umbrella!

Color: Pink, Dark Red, Royal Blue, Navy Blue, Grey, and Black assorted



### SA-19-211

#### Twin Umbrella with Automatic Function

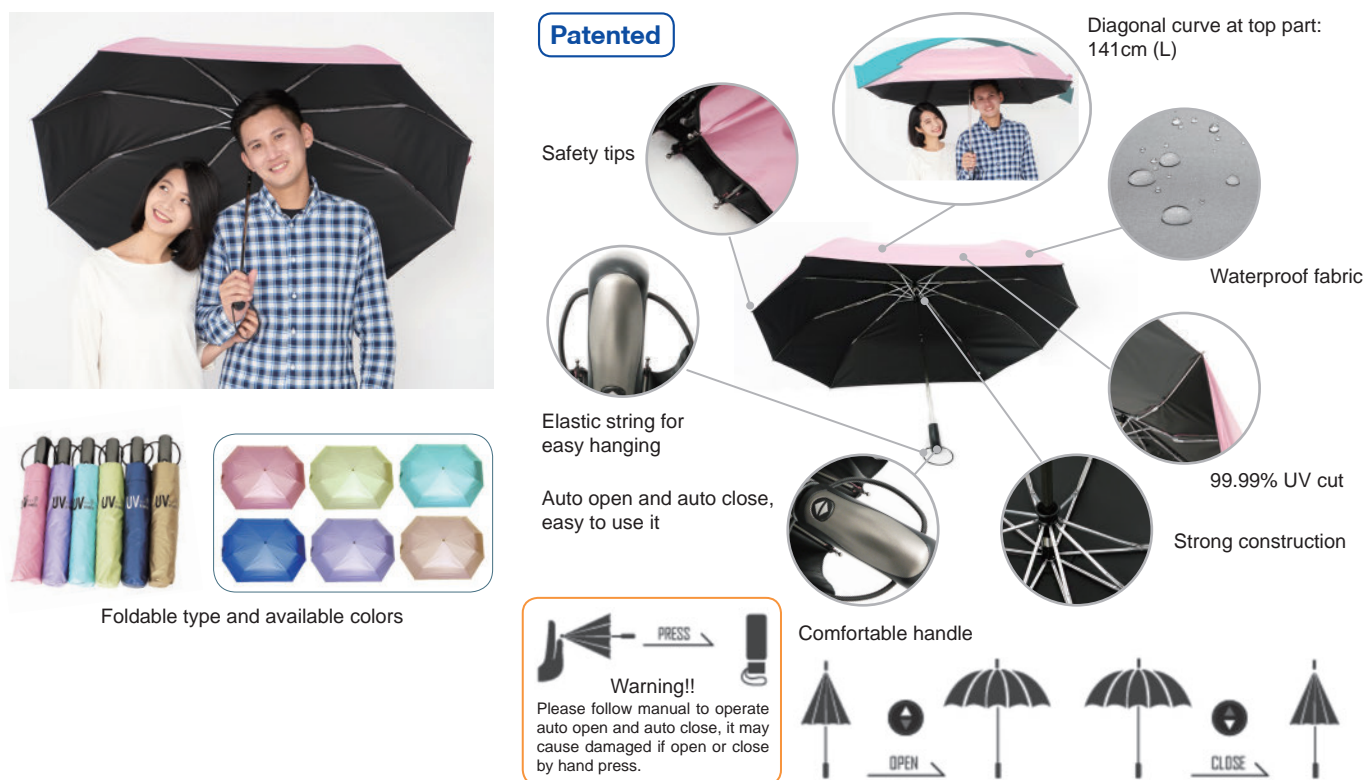



## Portable Cooler



### SC-10-001-2 EX

#### Cooling Maker, Air Cooler, Portable Air Cooling System for Car

Portable Air Conditioner Fan with 12V Cigarette Lighter Plug

Suitable Usage: In the Certain Space, Such as Car or Tent

Cooling Ability: Compared to Certain Spaces, the Temperature Drops 5°C to 8°C

Product Dimension: (L) 57.3cm x (W) 30cm x (H) 31cm

Weight: N.W.: 4.87 KGS / G.W.: 5.74 KGS

Capacity: 18 L

Patent no.: I656306



Cooling ability: Compared to certain spaces, the temperature drops Air cooler only use 12V cigarette lighter plug or portable power bank (battery) to supply power. It can be used for cars and tents, it also fits small spaces such as office, bedroom etc. The used water can reuse to water flowers or make ice bricks again. It is electricity-saving and eco-friendly.

### Description

Cooling Maker SC-10-001 works like a home air conditioner, but with more flexible uses. It can be used inside a vehicle, a dining car, a camping car, or a tent. It can also fit into small spaces in the office, bedroom, or living room.

The basic mechanism of the cooling maker consists of a build-in compact radiator, two fans, and one pump. Pour in water, and add ice cube or ice brick. After the water becomes cold it will rush through the radiator. The fans and pump will then deliver cold air that can lower temperature up to 5° to 8° degree C for up to 4 ~ 7 hours depends on ambient temperature.

Using less than 12W of power, the Cooling Maker is power-saving and environmentally friendly.

Capacity is 18L and voltage is 12V. Accessories include one 12V cigar power cable. When using in a car, the power from cigarette lighter will stop if the engine is turned off. Consumer needs a portable power bank (battery) to keep the cool air flowing.

Cooling maker is easy to operate. With sufficient water & ice (please note that water level should be higher than pump), then turn on the fan speed controller). Soon you will feel the cool air from the vent holes.

Cooling maker is certified with patent of invention under number I656306.

### Product Invention Story

In Japan, there are many couples, even retired couples, who will arrange to travel around Japan to enjoy romantic couple life.

During the journey, the most expensive is accommodation, so many travelers will choose to drive or rent a modified car to sleep in the car at night

But on a hot summer night, when the car is stopped and turned off, when the car's air conditioner is not available, it always feels too hot to sleep,

This product has obtained an invention patent. As long as this product is added to ice cubes and water, the temperature can be instantly reduced to 5 ~ 8°C. and enjoy the same cooler air in dry.

## Cooler Box for Fishing, Picnic, and etc.

### SC-10-CB101

#### Fishing Cooler Box

With Handle, and Strap for carry on easily

Product dimension: (L) 57.3cm x (W) 30cm x (H) 31cm

Capacity: 18 L

Material: PP, ABS

**\*\*Japan exclusive**



### SC-10-CB104

#### Fishing Cooler Box

With Handle, and Strap for carry on easily

Product dimension: (L) 62.7cm x (W) 34.5cm x (H) 34.5cm

Capacity: 26.4 L

Material: PP, ABS

**\*\*Japan exclusive**



### SC-10-CB105

#### Fishing Cooler Box

With Handle, and Strap for carry on easily

Product dimension: (L) 57.1cm x (W) 31cm x (H) 33.7cm

Capacity: 24.3 L

Material: PP, ABS

**\*\*Japan exclusive**



### SC-10-CB106

#### Fishing Cooler Box

With Handle, and Strap for carry on easily

Product dimension: (L) 31cm x (W) 19.5cm x (H) 21cm

Capacity: 5.9 L

Material: PP, ABS

**\*\*Japan exclusive**



### SC-10-CB106AP

#### Fishing Cooler Box with Bait Net and Pump

With Handle, and Strap for carry on easily

Product dimension: (L) 31cm x (W) 19.5cm x (H) 21cm (not including the pump)

Capacity: 5.9 L

Material: PP, ABS

**\*\*Japan and USA exclusive**



## Fishing Appliance - Rubber Landing Net

We develop a better fishing net to solve many of the functional and performance problems of traditional products. In recent years, the increase in fishing tools and accessories to meet specific angler applications and requirements has become an increasingly important part of the business.

The soft mesh material is scratch-resistant and does not hurt the fish. Non-slip handle, comfortable and durable to hold.

The position of the lock can be placed at will, practical and convenient.

The floating fishing net is light in weight and easy to catch fish.

Suitable for go fishing, freshwater aquaculture aquarium, villa park factory fish pond salvage

### Feature:

- Stretchy design - to fit a fish full length
- Well secured to protect and cushion the catch safely from damage and scuffs.
- Featured one-piece, seamless, elastic, durable and snag-free.

### Remark:

Heat resistance:  $60^{\circ}\text{C} \pm 5^{\circ}\text{C}$

Cold resistance:  $-15^{\circ}\text{C} \pm 5^{\circ}\text{C}$

### SC-10-RLN012L170

#### Rubber Landing Net w/Aluminum Alloy Handle & Foam

Net in Light style

Net: 12.5" Dia. x 24 cm Depth

Max. loading capacity: 3 kgs

Hoop size: L380 x W303 mm

Handle length: 170 mm

Overall length: 555 mm

Net color: Black or Transparent



### SC-10-RLN012L160W

#### Rubber Landing Net w/Wooden Handle

Net in Light style

Net: 12.5" Dia. x 24 cm Depth

Max. loading capacity: 3 kgs

Hoop size: L400 x W295 mm

Handle length: 160 mm

Overall length: 560 mm

Net color: Black or Transparent



## Fishing Appliance - Rubber Landing Net

### SC-10-RLN015L400

#### Rubber Landing Net w/Aluminum Alloy Handle & Foam

Net in Light style

Net: 15" Dia. x 27.7 cm Depth

Max. loading capacity: 5 kgs

Hoop size: L455 x W370 mm

Handle length: 400 mm

Overall length: 860 mm

Net color: Black or Transparent

Adjustable Handle for easy to carry and save freight charge for shipment



### SC-10-RLN019LM720

#### Rubber Landing Net w/Aluminum Alloy Handle & Foam

Net in Light style

Net: 19" Dia. x 45 cm Depth

Max. loading capacity: 7 kgs

Hoop size: L535 x W415 mm

Handle length: 720 mm

Overall length: 1240 mm

Net color: Black or Transparent

Adjustable Handle for easy to carry and save freight charge for shipment

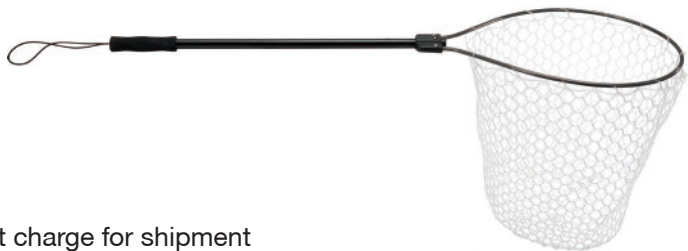

### SC-10-RLN019LD760

#### Rubber Landing Net w/Aluminum Alloy Handle & Foam

Net in light & deep style

Net: 19" Dia. x 60 cm Depth

Max. loading capacity: 7 kgs

Hoop size: L535 x W415 mm

Handle length: 760 mm

Overall length: 1300 mm

Net color: Black or Transparent

Adjustable Handle for easy to carry and save freight charge for shipment

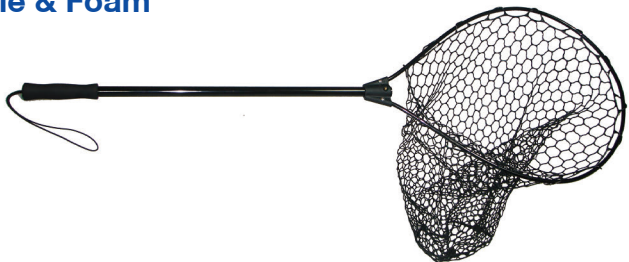

### SC-10-RLN024L1110

#### Rubber Landing Net w/Aluminum Alloy Handle & Foam

Net in Light style

Net: 24" Dia. x 32.6 cm Depth

Max. loading capacity: 10 kgs

Hoop size: L680 x W565 mm

Handle length: 1110 mm

Overall length: 1780 mm

Net color: Black or Transparent

Adjustable Handle for easy to carry and save freight charge for shipment









## Sunny Technologies Co.,Ltd.

11F-3, No. 2, Ln. 212, Sec. 3, Heping E. Rd., Da'an Dist.,  
Taipei City 10674, Taiwan

Tel: 886-2-27352298 Fax: 886-2-27330076

<http://www.sunnytec.com>